

# OREM 1, 2, 9, & OREM UTAH STAKE PARTITION, ACCORDION INSTALLATION

80 SOUTH 280 EAST  
OREM, UTAH  
PROPERTY # 513-0239

APRIL 2018

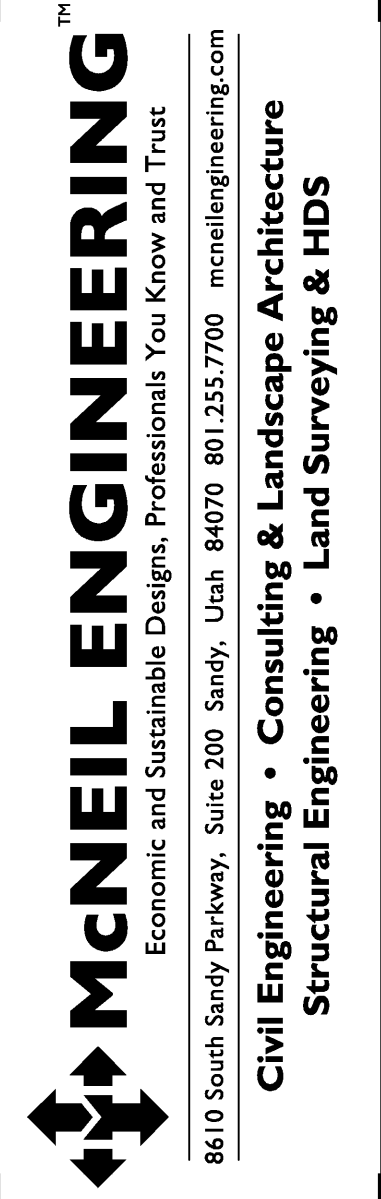

**OREM 1, 2, 9, &  
OREM UTAH STAKE**  
The Church of Jesus Christ of Latter-Day Saints  
80 SOUTH 280 EAST  
OREM, UTAH

REV	DATE	DESCRIPTION

PROJECT NO: 17064  
DRAWN BY: MGS  
CHECKED BY: RJD/CEG  
DATE: APRIL 2018  
PROP NO: 513-0239

COVER SHEET

**G1.00**

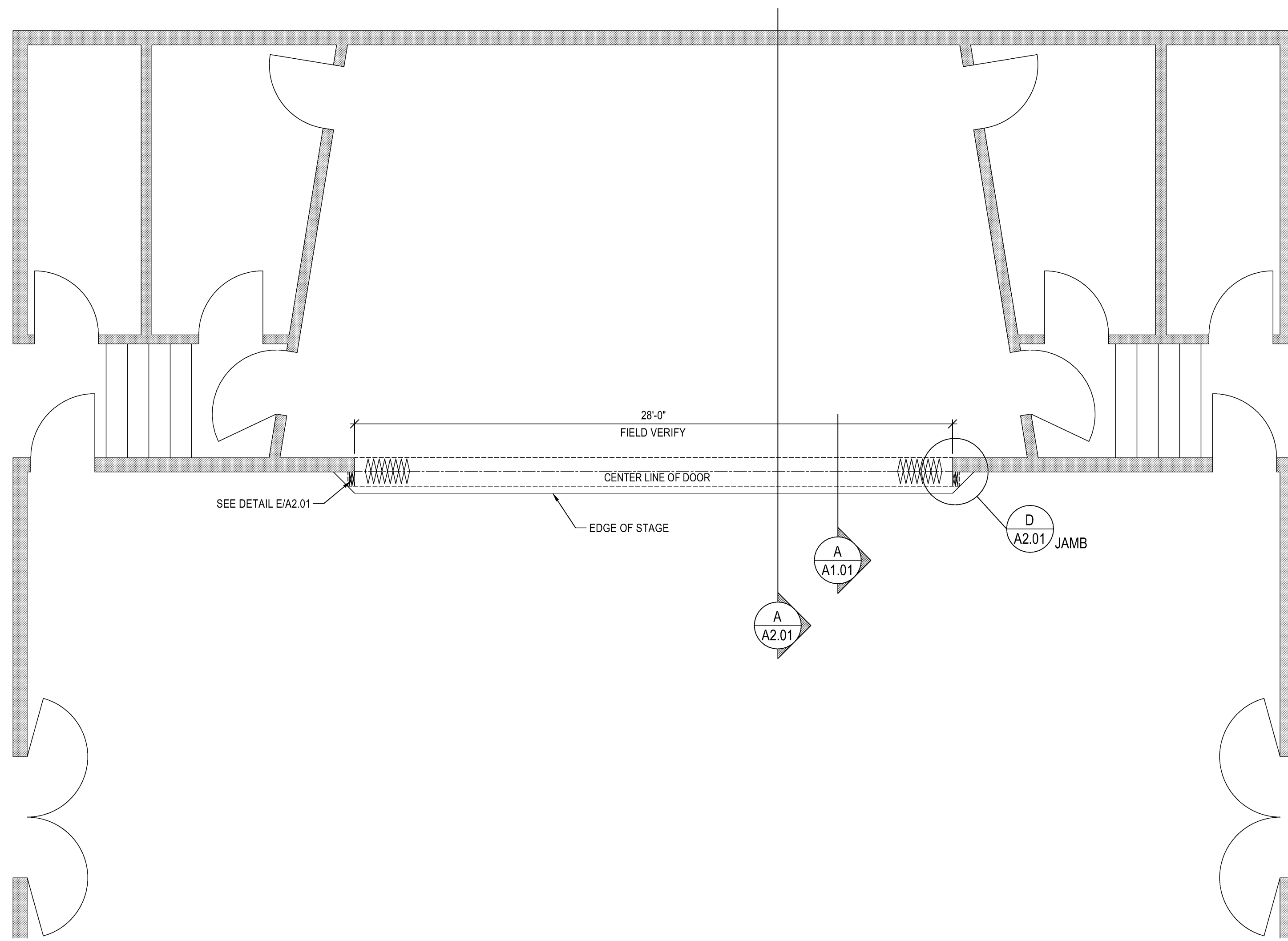

**PLAN VIEW**  
SCALE: 1/4" = 1'-0"

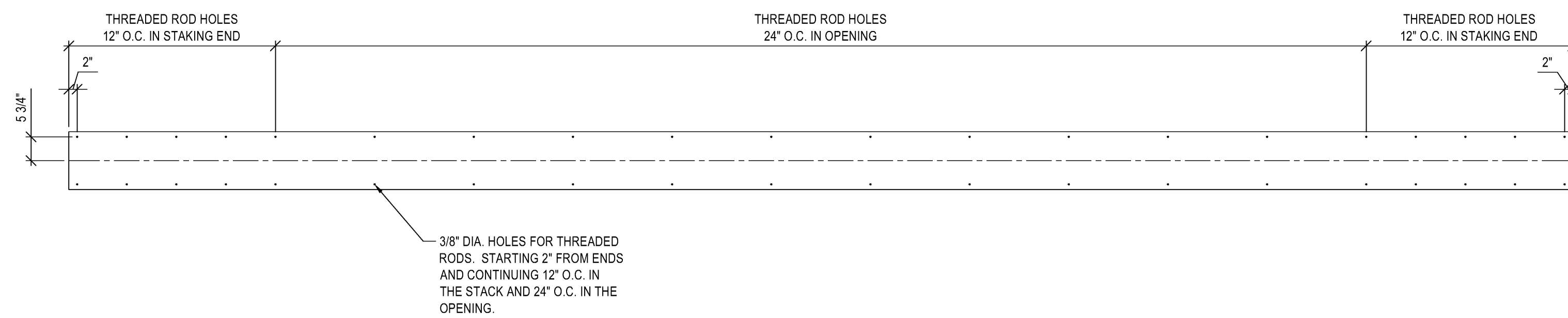

**ADJUSTABLE PLYWOOD HEADER (PLAN VIEW)**  
SCALE: 1/2" = 1'-0"

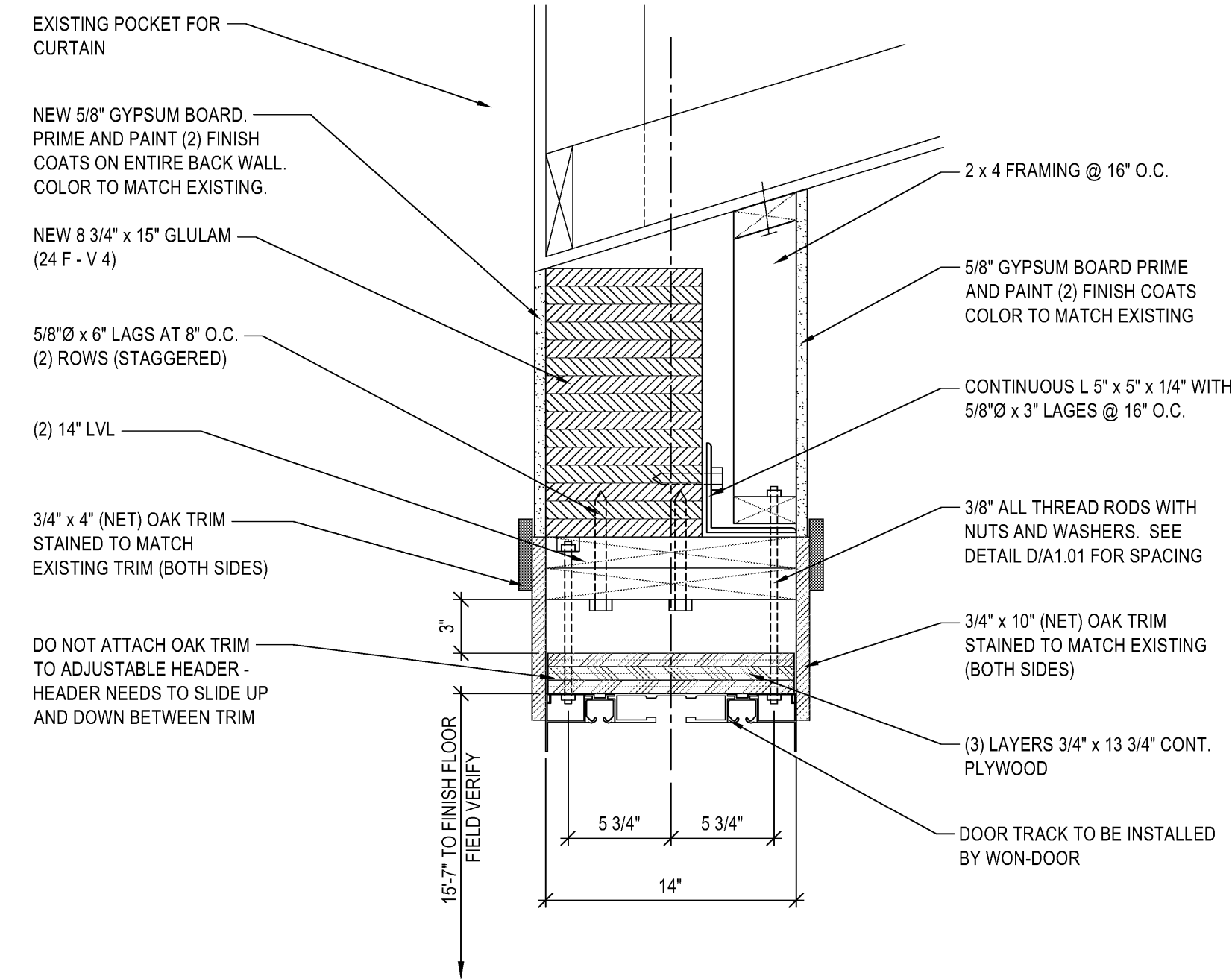

**A HEADER DETAIL**  
SCALE: 1/2" = 1'-0"

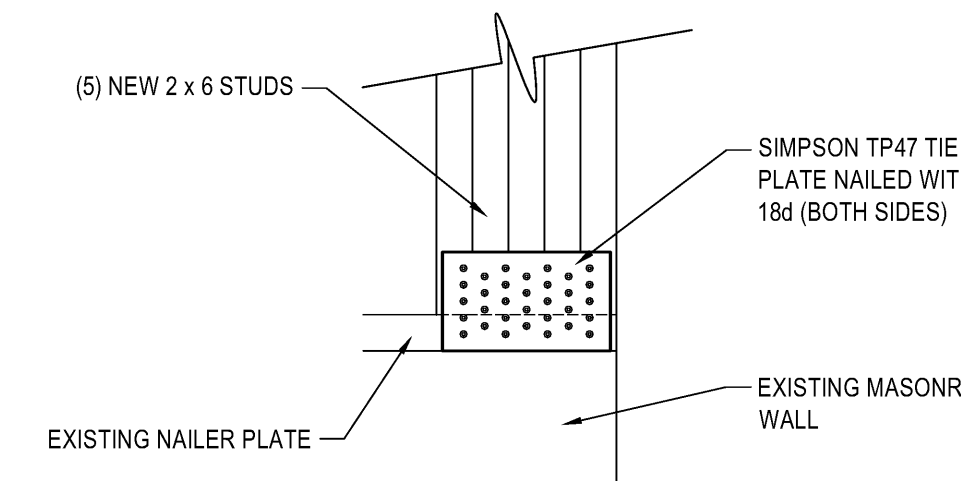

**B POST BASE DETAIL**  
SCALE: 1 1/2" = 1'-0"

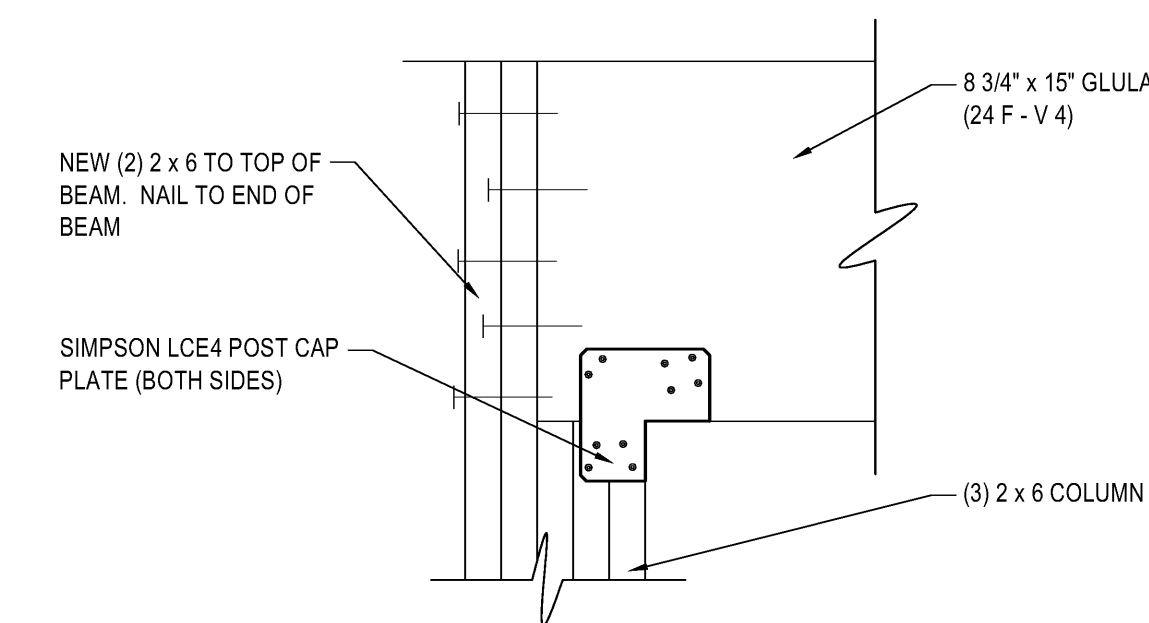

**D COLUMN CONNECTION DETAIL**  
SCALE: 1 1/2" = 1'-0"

- SCOPE OF WORK:**  
PROVIDE, INSTALL AND/OR CONSTRUCT THE FOLLOWING PER THE SPECIFICATIONS GIVEN OR REFERENCED AND THE DETAILS NOTED AND AS SHOWN ON THE CONSTRUCTION DRAWINGS:
- CUT AND REMOVE AREAS OF GYPSUM BOARD AND INSTALL NEW FRAMING AS PER HEADER DETAIL A/A1.01.
  - INSTALL NEW JAMB FRAMING AS SHOWN. SEE DETAILS C&D/A2.01.
  - REMOVE, CUT, AND REINSTALL OAK TRIM AS REQUIRED TO TIE INTO NEW TRIM. INSTALL NEW OAK TRIM AS SHOWN. PAINT AND STAIN TO MATCH EXISTING. CONTRACTOR IS RESPONSIBLE TO REPLACE ANY WOOD OR TRIM DAMAGED DURING CONSTRUCTION.
  - ALL NEW GYPSUM BOARD WALLS TO BE PRIMED AND PAINTED WITH (2) COATS OF PAINT. MATCH EXISTING COLOR. PAINT ENTIRE WALL OF AREA WHERE NEW WORK OCCURRED.
  - INSTALL NEW CORNELL MODEL ESP20 FOLDING DOOR. COLOR TO MATCH EXISTING DOOR BETWEEN OVERFLOW AND CULTURAL HALL.
  - REMOVE AND REINSTALL EXISTING STAGE TRACK LIGHTS INSIDE POCKET AREAS. PATCH AND PAINT ANY HOLES.

S:\2017files\17064\Consulting\Prod Draw\17064-FIN.dwg Melissa Apr 16, 2018 - 2:06pm

REV	DATE	DESCRIPTION

PROJECT NO: 17064  
DRAWN BY: MGS  
CHECKED BY: RJD/CEG  
DATE: APRIL 2018  
PROP NO: 513-0239

**FLOOR PLAN, AND DETAILS**

**A1.01**

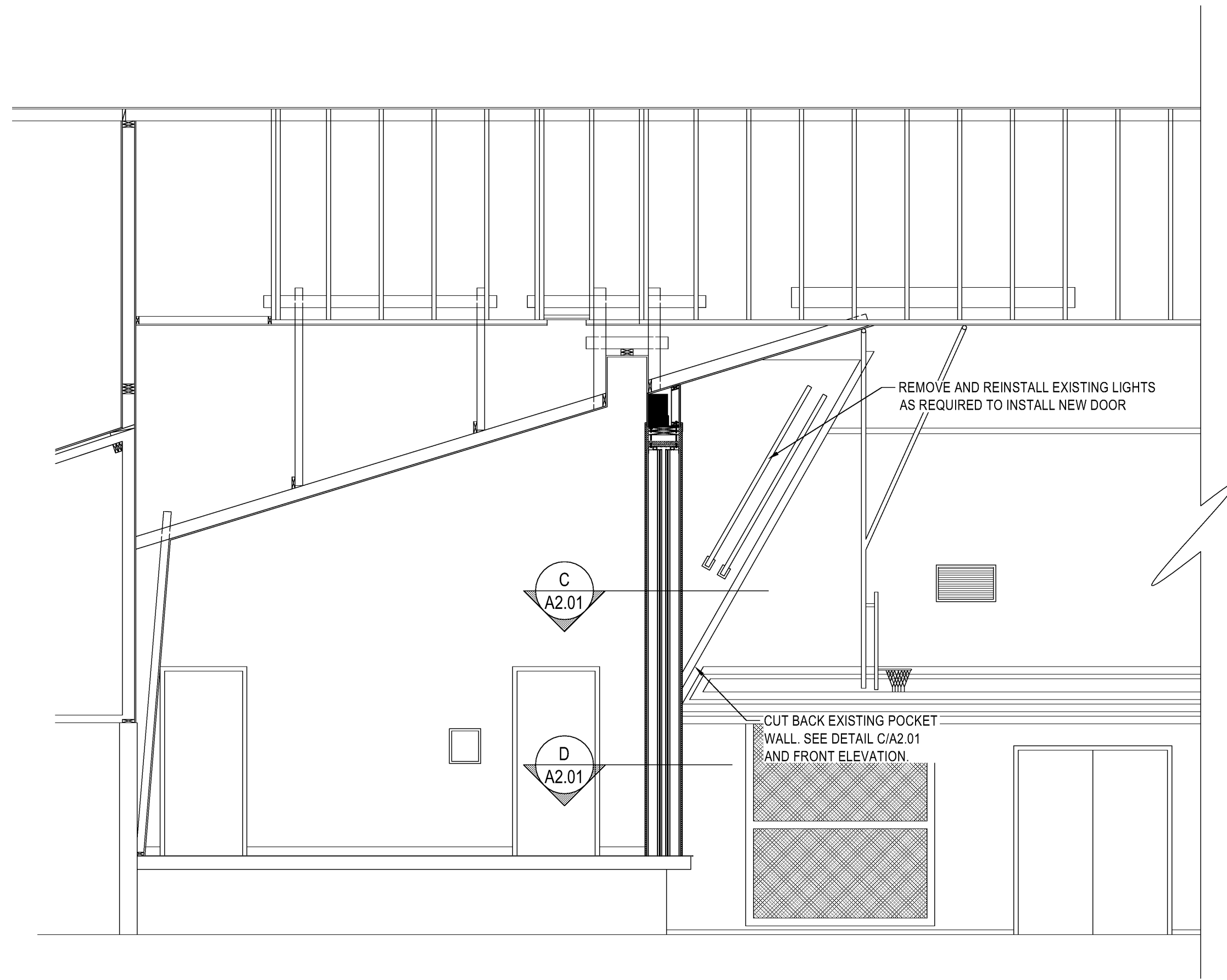

**A** DOOR SECTION  
SCALE: 1/4" = 1'-0"

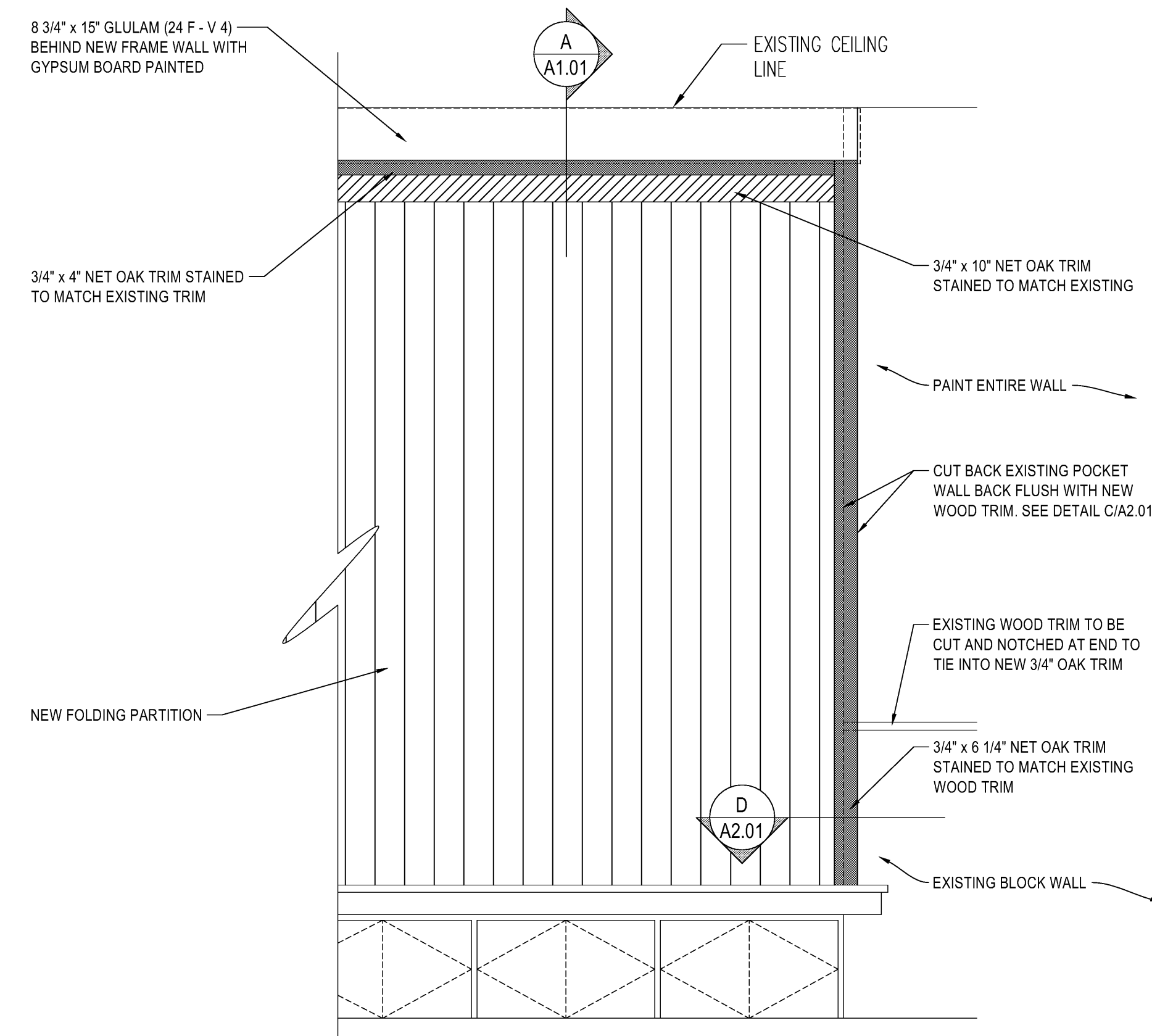

**B** FRONT ELEVATION  
SCALE: 1/8" = 1'-0"

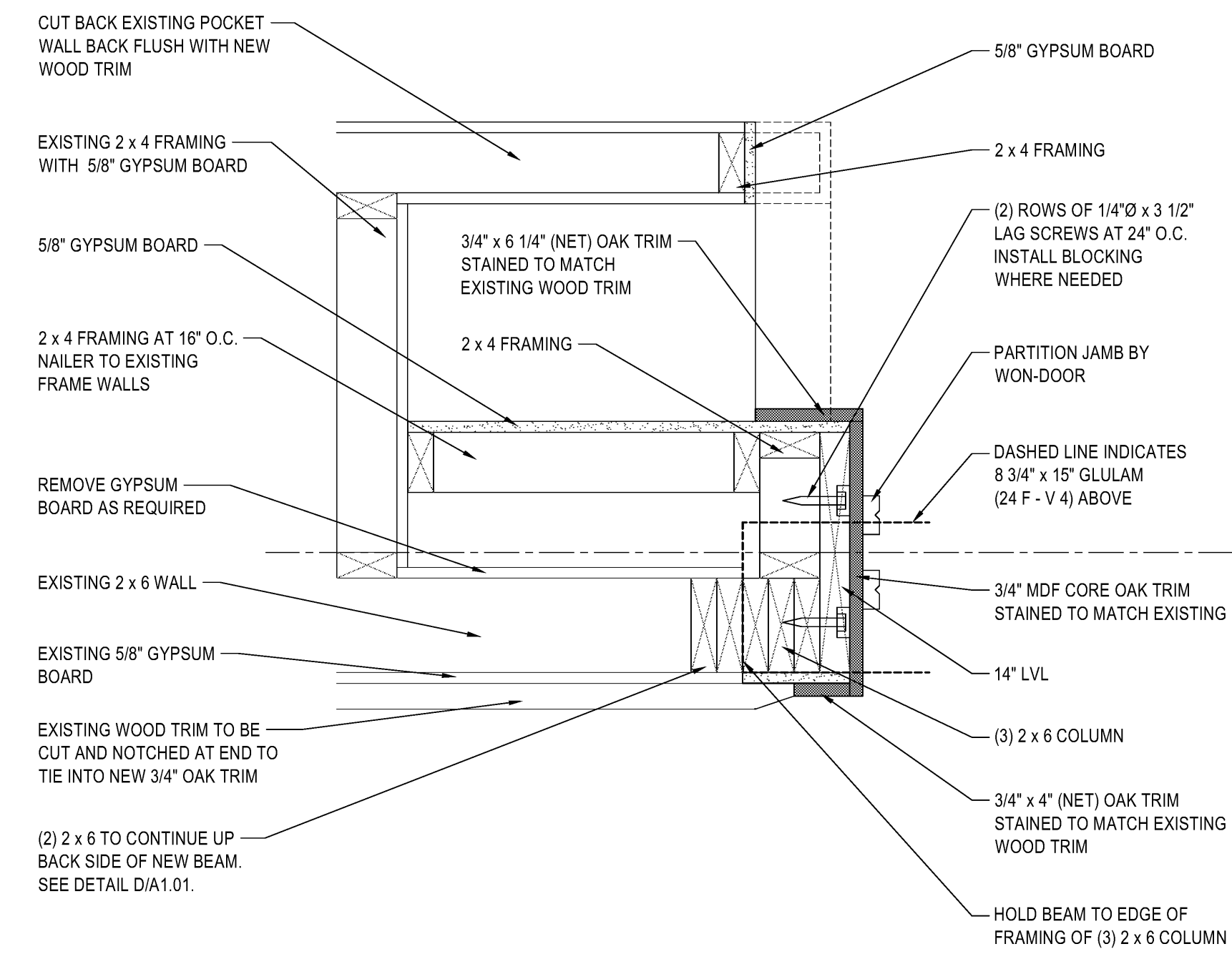

**C** JAMB DETAIL  
SCALE: 1 1/2" = 1'-0"

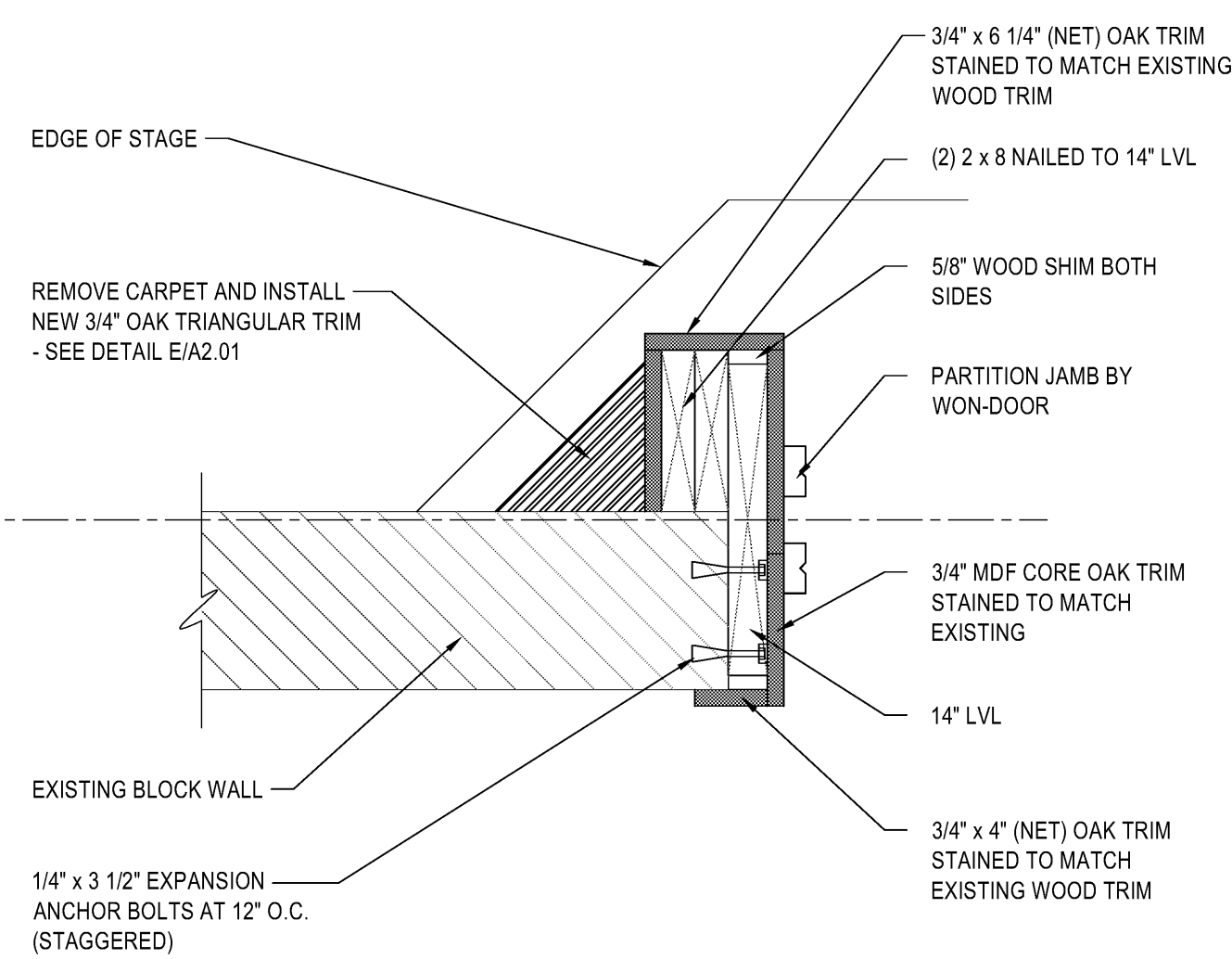

**D** JAMB DETAIL  
SCALE: 1 1/2" = 1'-0"

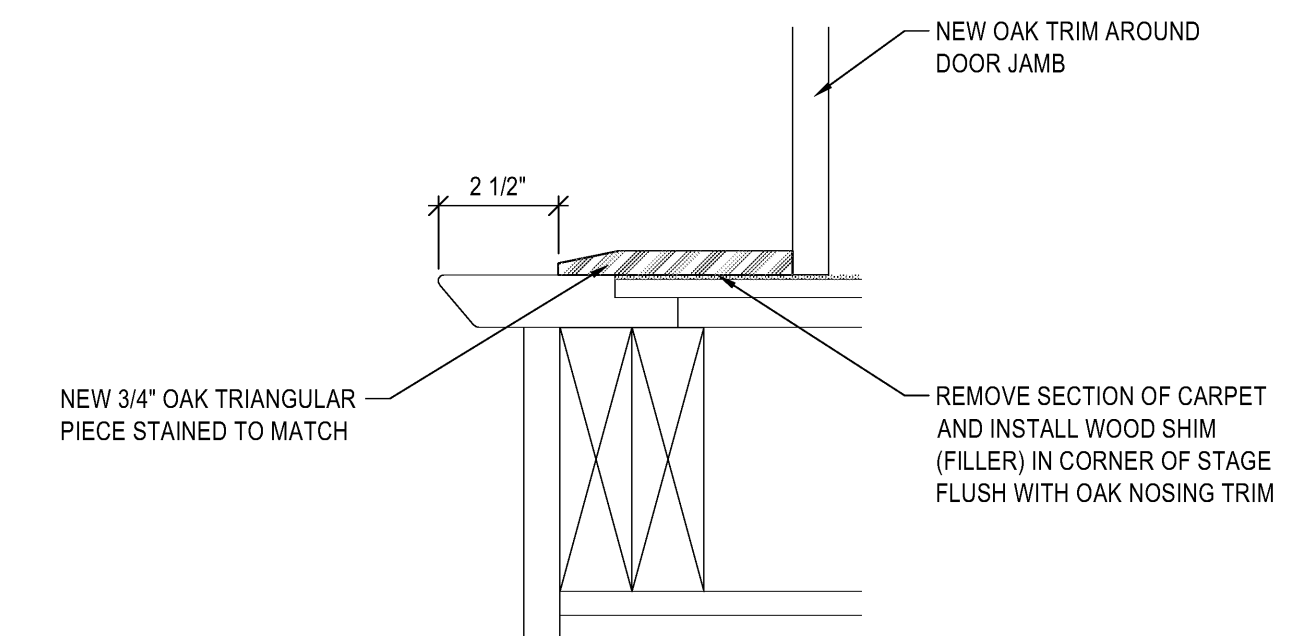

**E** STAGE DETAIL  
SCALE: N.T.S.

REV	DATE	DESCRIPTION

PROJECT NO: 17064  
DRAWN BY: MGS  
CHECKED BY: RJD/ CEG  
DATE: APRIL 2018  
PROP NO: 513-0239

**ELEVATION,  
SECTION, AND  
DETAILS**

**A2.01**

S:\2017files\17064\Consulting\Prod Draw\17064-PLN.dwg Melissa Apr 16, 2018 - 2:06pm